

# CITY OF HOPKINS

## CONSTRUCTION PLANS FOR BLAKE ROAD SIDEWALK IMPROVEMENTS

- EXISTING**
- COUNTY LINE
  - CITY LIMITS
  - SECTION LINE
  - PRESENT RIGHT OF WAY LINE
  - PROPERTY/LOTLINE
  - PERPETUAL EASEMENT
  - ZONING SETBACK LINE
  - ACCESS CONTROL LINE
  - RAILROAD RIGHT OF WAY LINE
  - RAILROAD
  - WATER EDGE
  - WATER CENTERLINE
  - HIGHWATER LINE
  - SWALE CENTERLINE
  - WETLAND BOUNDARY
  - WETLAND/MARSH
  - CURB & GUTTER
  - CONCRETE EDGE
  - BITUMINOUS EDGE
  - GRAVEL EDGE
  - FENCE
  - CULVERT
  - DECIDUOUS TREE
  - CONIFER TREE
  - HEDGE
  - TREE LINE
  - TRAFFIC SIGN
  - MANHOLE
  - CATCH BASIN
  - SANITARY SEWER
  - SANITARY FORCEMAIN
  - 15" STM INP
  - STORM SEWER
  - TILE LINE
  - WATERMAIN
  - 4" WMN INP
  - HYDRANT
  - VALVE
  - CURB STOP
  - GAS
  - POWER POLE
  - LIGHT POLE
  - PAD MOUNTED TRANSFORMER
  - UNDERGROUND ELECTRIC
  - OVERHEAD ELECTRIC
  - UTILITY PEDestal/CABINET
  - UNDERGROUND TELEPHONE
  - UNDERGROUND TV CABLE
  - TV
  - BENCHMARK
  - SOIL BORING
  - B-3
- PROPOSED**
- 22'-0" ALUMINUM/CENTERLINE
  - RIGHT OF WAY LINE
  - TEMPORARY EASEMENT
  - CONSTRUCTION LIMITS
  - CURB & GUTTER
  - BITUMINOUS EDGE
  - CONCRETE EDGE
  - GRAVEL EDGE
  - SILT FENCE-PRESCREENABLE
  - SILT FENCE-HEAVY DUTY
  - EROSION PROTECTION AT INLET
  - MANHOLE
  - CATCH BASIN
  - SANITARY SEWER
  - 8" SAN
  - 6" FM
  - SANITARY FORCEMAIN
  - SANITARY LIFT STATION
  - 12" STM
  - STORM SEWER
  - 4" PERF. PD.
  - PERFORATED PIPE DRAIN
  - CULVERT W/ APRON
  - HYDRANT
  - VALVE
  - CURBSTOP
  - WATERMAIN

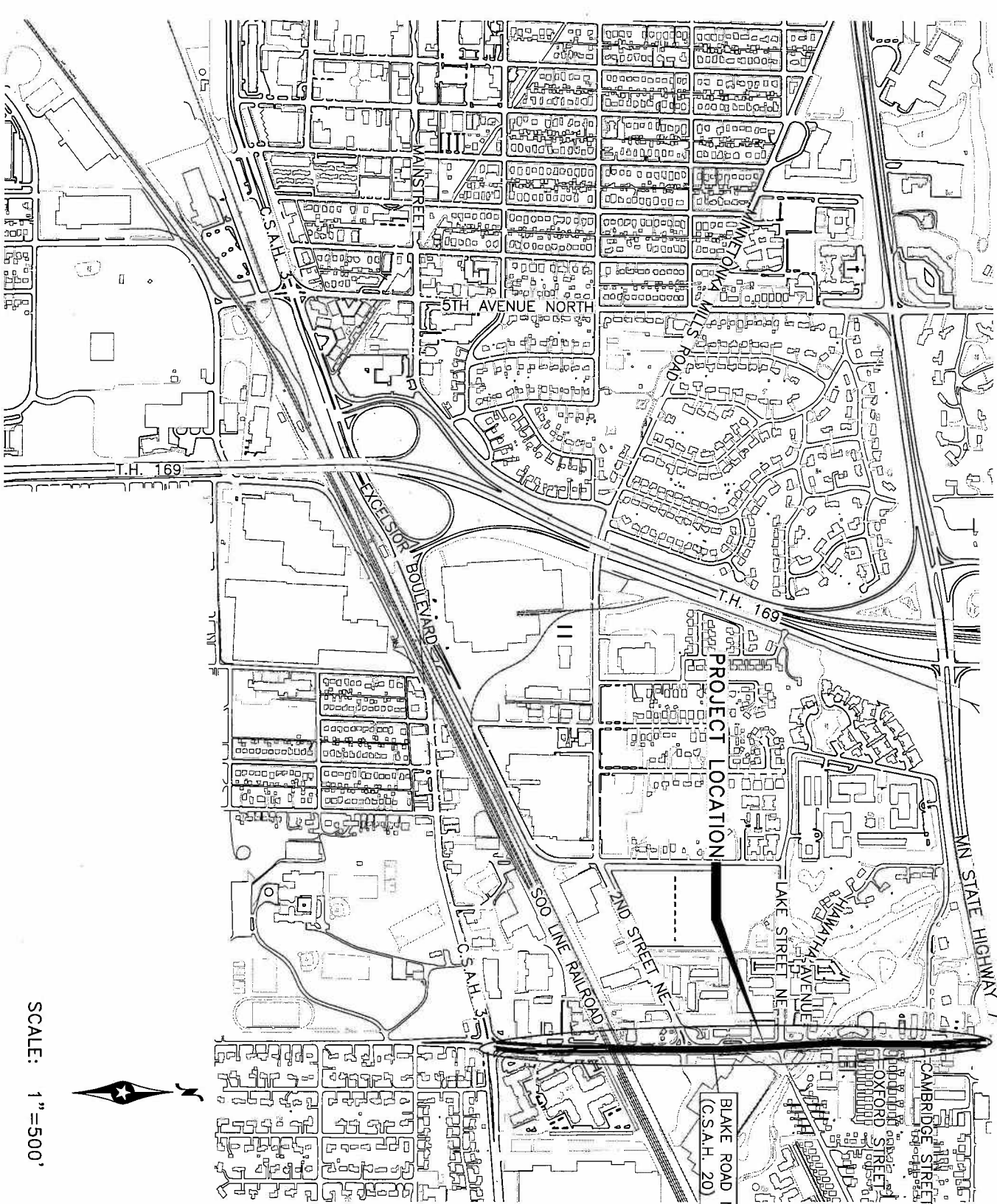

SCALE: 1"=500'



MAP OF THE  
CITY OF HOPKINS  
HENNEPIN COUNTY, MN

**BOLTON & MENK, INC.**  
Consulting Engineers & Surveyors  
MANKATO, MN FARMINGTON, MN SLEEPY EYE, MN WILLMAR, MN  
BURNSVILLE, MN CHASICA, MN RAMSEY, MN AWES, IA

SECTION NO.	TITLE
1	TITLE SHEET
2-3	TYPICAL SECTIONS & DETAILS
4-7	CONSTRUCTION PLANS
8-9	STORMWATER POLLUTION PREVENTION PLAN (SWPPP)

THIS PLAN SET CONSISTS OF 9 SHEETS  
RESOURCE LIST

- CITY OF HOPKINS**
- CITY HALL  
1010 1ST ST.  
HOPKINS, MN 55343-7573  
952-935-8474
- PUBLIC WORKS DIRECTOR  
MR. STEVE STADLER P.E.
- CITY ENGINEER  
MR. JOHN BRADFORD P.E.
- CONSULTING ENGINEER
- BOLTON & MENK, INC.**  
12224 NICOLET AVENUE  
BURNSVILLE, MN 55337-1649  
952-890-0509
- PROJECT MANAGER  
MR. MARCUS A. THOMAS P.E.
- PROJECT ENGINEER  
MS. SARAH E. RIPPKÉ P.E.
- UTILITIES**
- CENTERPOINT ENERGY**  
700 WEST LINDEN AVENUE  
MINNEAPOLIS, MN 55403  
MR. DEAN NICHOLS  
612-321-5581  
612-321-5480 FAX
- ONEST COMMUNICATIONS**  
6244 GEORGE AVENUE SOUTH  
RICHFIELD, MN 55423  
MS. SARAH HEDLUND  
612-861-8173 FAX  
912-861-8173 FAX
- FIELD CONTACT:**  
MR. GREG SAUER  
612-386-8682 (CELL)
- SPRINT**  
849 EARL ST.  
SAINT PAUL, MN 55106  
MR. DAN HILLARD  
952-321-0379  
952-321-0379  
651-772-0714
- AT&T**  
MR. KELLY FALLS  
kfall@att.com  
650-684-7719
- XLCEL ENERGY**  
5309 WEST 70TH STREET  
LONDON, MN 55459  
MR. LINDA STINSON  
952-929-8574  
952-929-4558 FAX
- MCLEOD USA**  
2996 CENTERPOINTE DRIVE  
ROSEVILLE, MN 55113  
MR. BRANT SANDERS  
952-238-4511
- TM TELECOM**  
5480 FETTER ROAD  
MINNETONKA, MN 55343  
MR. BOB STRONG  
952-351-2353  
612-805-8827 (CELL)
- COMCAST**  
9705 DATA PARK  
MINNETONKA, MN 55343  
MR. KELLY DOONAN  
612-287-3632  
952-607-4363 FAX
- MR. DAVE LINDROFF**  
651-366-5750

NOTE:  
EXISTING UTILITY INFORMATION SHOWN ON THIS PLAN HAS BEEN PROVIDED BY THE UTILITY OWNER. THE CONTRACTOR SHALL FIELD VERIFY EXACT LOCATIONS PRIOR TO COMMENCING CONSTRUCTION AS REQUIRED BY STATE LAW.  
NOTIFY BODHER STATE ONE-CALL 1-800-252-1186 OR 651-454-5002.

THE SUBSURFACE UTILITY INFORMATION IN THIS PLAN IS UTILITY QUALITY LEVEL D. C/A/SEC 38-02. EXEMPTED STANDARD GUIDELINES FOR THE COLLECTION AND DEFINITION OF EXISTING SUBSURFACE UTILITY DATA.

I HEREBY CERTIFY THAT THIS PLAN, SPECIFICATION, OR REPORT WAS PREPARED BY ME OR UNDER MY SUPERVISION AND THAT I AM A DULY LICENSED PROFESSIONAL ENGINEER UNDER THE LAWS OF THE STATE OF MINNESOTA.

SARAH E. RIPPKÉ U.C. NO. 46636 DATE: \_\_\_\_\_

REVIEWED & APPROVED \_\_\_\_\_ DATE: \_\_\_\_\_  
CITY OF HOPKINS

RECORD DRAWING INFORMATION	CITY OF HOPKINS	SHEET
DATE:	BLAKE ROAD SIDEWALK IMPROVEMENTS	1 OF 9
CONTRACTOR:	TITLE SHEET	

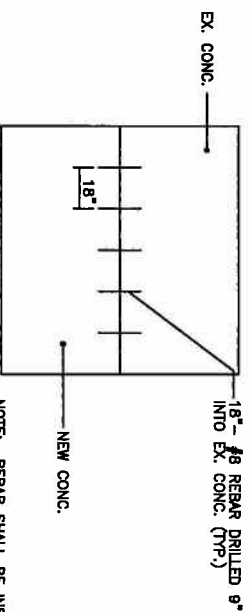

**DOWEL BAR PLACEMENT  
ALONG CONCRETE  
STREET PATCHES**

NOTE: REBAR SHALL BE INSTALLED AT A DEPTH OF ONE-HALF THE CONCRETE SLAB THICKNESS.

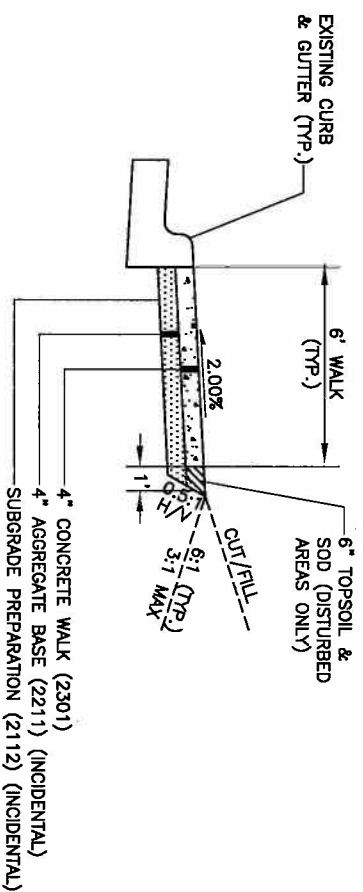

**CONCRETE WALK  
TYPICAL SECTION**

TYPICAL SECTION NOTES:

1. WIDTHS CAN VARY FROM THOSE SHOWN ON THE TYPICAL SECTION. SEE THE PLAN SHEETS FOR VARIATIONS FROM THE TYPICAL SECTION.
2. ALL DISTURBED BOULEVARD AREAS SHALL BE RESTORED WITH 6" TOPSOIL AND SOD.

**GENERAL CONSTRUCTION NOTES:**

1. NO CONSTRUCTION ACTIVITY SHALL OCCUR WITHIN RAILROAD RIGHT-OF-WAY.
2. CONTRACTOR IS RESPONSIBLE FOR ALL STAKING DURING CONSTRUCTION.
3. ALL TRAFFIC CONTROL DEVICES AND LAYOUTS SHALL CONFORM TO THE MOST RECENT MN MUTCD MANUAL.
4. THE CONTRACTOR SHALL SUBMIT A TRAFFIC CONTROL PLAN TO THE ENGINEER. THE TRAFFIC CONTROL PLAN MUST BE APPROVED PRIOR TO BEGINNING ANY WORK THAT AFFECTS TRAFFIC FLOW ALONG BLAKE ROAD NORTH.
5. THE PAVEMENT SECTION SHOWN FOR STREET PATCHING IS APPROXIMATE. THE CONTRACTOR SHALL MATCH THE EXISTING STREET PAVEMENT AND AGGREGATE BASE SECTIONS PRESENT AT THE PATCH LIMITS.
6. THE CONCRETE MEDIAN APPROACH NOSE SHALL BE CONSTRUCTED PER MN/DOT STANDARD PLATE 7113A.
7. THE CONTRACTOR SHALL PROTECT ALL IN PLACE PEDESTRIAN FACILITIES UNLESS MARKED FOR REMOVAL BY THE ENGINEER.

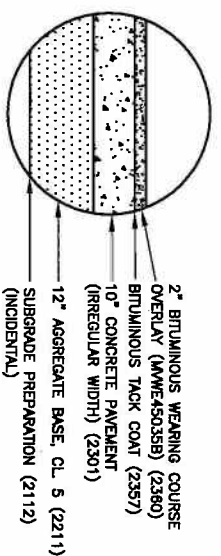

**BLAKE ROAD STREET PATCH  
TYPICAL SECTION**

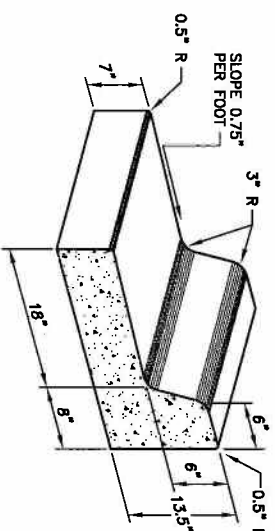

**CONCRETE CURB & GUTTER  
DESIGN B618**

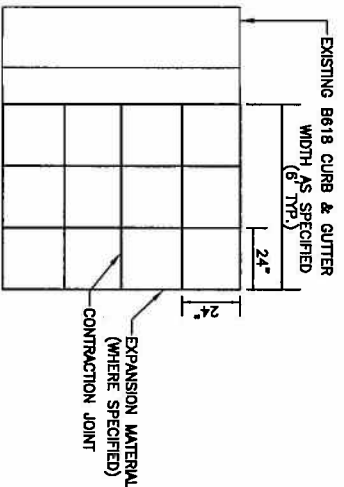

**CONCRETE WALK  
TYPICAL JOINTING PATTERN**

**CONDUIT INSTALLATION NOTES:**

1. THE CONTRACTOR SHALL LOCATE AND PROTECT EXISTING UTILITIES ALONG BLAKE ROAD NORTH. UTILIZE GOPHER STATE ONE CALL BEFORE DIGGING.
2. FINAL LOCATIONS OF THE PROPOSED CONDUIT SHALL BE DETERMINED IN THE FIELD AS REQUIRED TO PROTECT EXISTING UTILITIES.
3. THE CONDUIT SHALL BE INSTALLED TO A MINIMUM DEPTH OF 48" BELOW THE FINISHED SURFACE USING TRENCHLESS METHODS.
4. HAND HOLES SHALL BE CONSTRUCTED PER MN/DOT STANDARD PLATE 8117F1 & 8117F2 FOR PRECAST CONCRETE HAND HOLES.

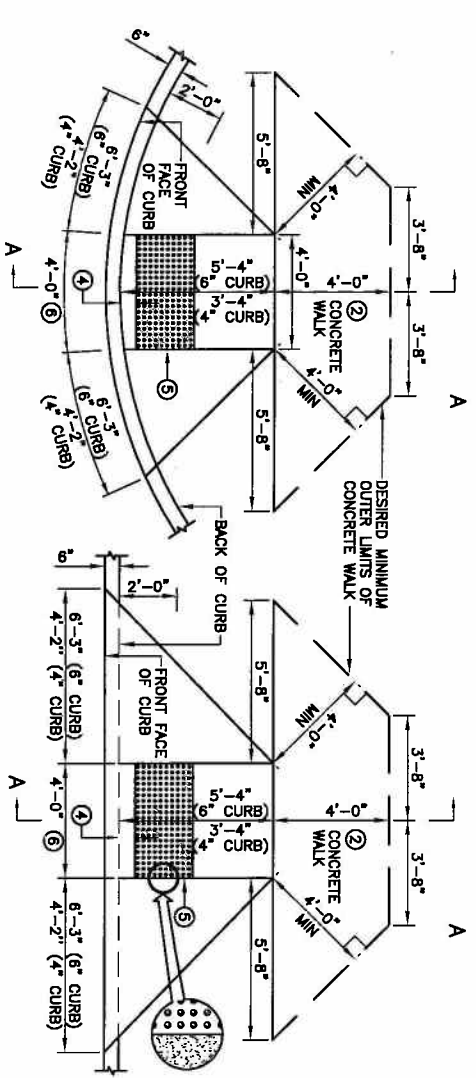

**PLAN VIEW OF DIAGONAL RAMP**

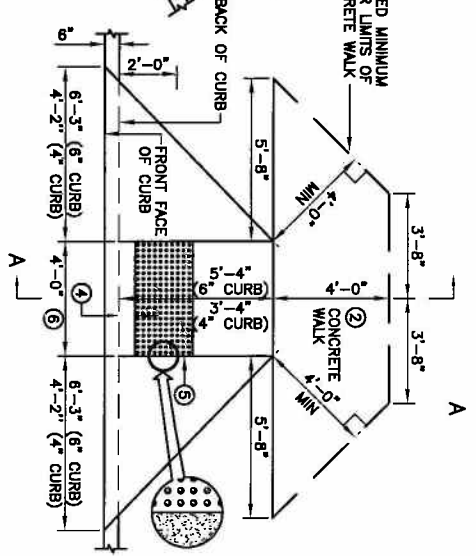

**PLAN VIEW OF PERPENDICULAR RAMP**

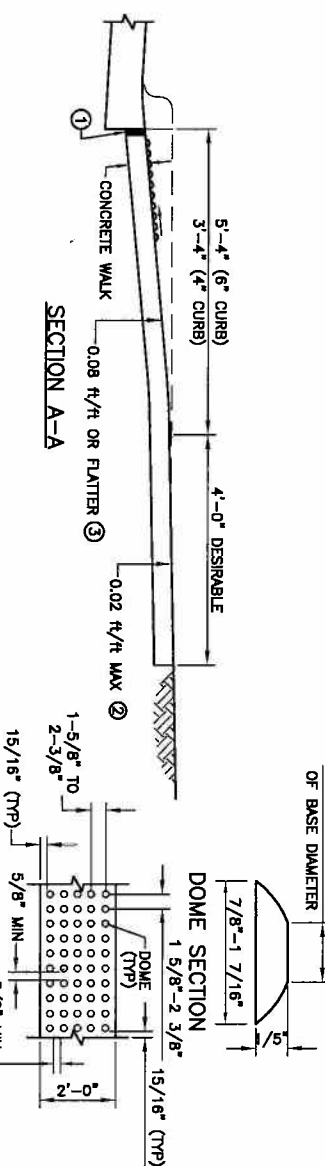

**SECTION A-A**

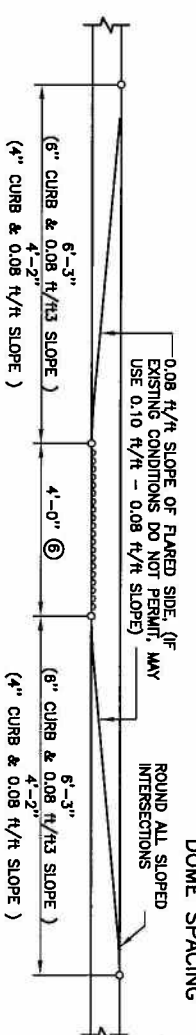

**ELEVATION OF RAMP**

- NOTES:**
- ① 1/2 INCH PREFORMED JOINT FILLER MATERIAL, ASHTO M 213.
  - ② WHEN POSSIBLE, PROVIDE A PATH OF TRAVEL 4'-0" WIDE BEHIND THE PEDESTRIAN RAMP. A RELATIVELY FLAT 4'x4' LANDING WILL ALLOW WHEELCHAIRS TO NAVIGATE AROUND THE PEDESTRIAN RAMP.
  - ③ WHEN A MEDIAN IS NOT WIDE ENOUGH FOR TWO PEDESTRIAN RAMPS AND A 48" LANDING BETWEEN THEM, THE PEDESTRIAN CROSSING SHALL BE CUT THROUGH THE MEDIAN AT STREET LEVEL.
  - ④ 4" TO 6" IS THE REQUIRED OFFSET OF THE DETECTABLE WARNINGS/TRUNCATED DOME AREA FROM THE BACK OF CURB.
  - ⑤ ADA REQUIRED TRUNCATED DOME AREA SHALL BE 2'-0" MIN. IN DIRECTION OF TRAVEL AND SHALL EXTEND THE FULL WIDTH (3'-0" OR 4'-0" TYP.) OF THE CURB RAMP. THIS 2'-0" BY 3'-0" OR 4'-0" WIDTH (TYP.) TRUNCATED DOME AREA SHALL BE A RED.
  - ⑥ 4'-0" FOR NEW CONSTRUCTION, 3'-0" ALLOWED FOR RETROPTS OR PRESERVATION PROJECTS.

**RED RAMP, WITH TRUNCATED DOMES,  
IN CURB RADIUS**

DETAILS ARE NOT TO SCALE

\\NOR\16100794\PLANS\Sheet 2 Details.dwg 6/10/09 4:12 pm

Edelson & Menk, Inc. 2009. All Rights Reserved

I HEREBY CERTIFY THAT THIS PLAN, SPECIFICATION, OR REPORT WAS PREPARED BY ME OR UNDER MY DIRECT SUPERVISION AND THAT I AM A DULY LICENSED PROFESSIONAL ENGINEER UNDER THE LAWS OF THE STATE OF MINNESOTA.  
SARAH E. RIPPKE DATE 4/6/2016

DESIGNED  
M.L.W.  
DRAWN  
M.L.W.  
CHECKED  
SER

**BOLTON & MENK, INC.**  
Consulting Engineers & Surveyors  
WANKATO, MN FAIRMONT, MN SLEEPY EYE, MN WILLMAR, MN  
BURNSVILLE, MN CHASKA, MN RAMSEY, MN AMES, IA

REL. BY DATE  
CITY OF HOPKINS  
BLAKE ROAD SIDEWALK IMPROVEMENTS

SHEET  
2  
OF  
9





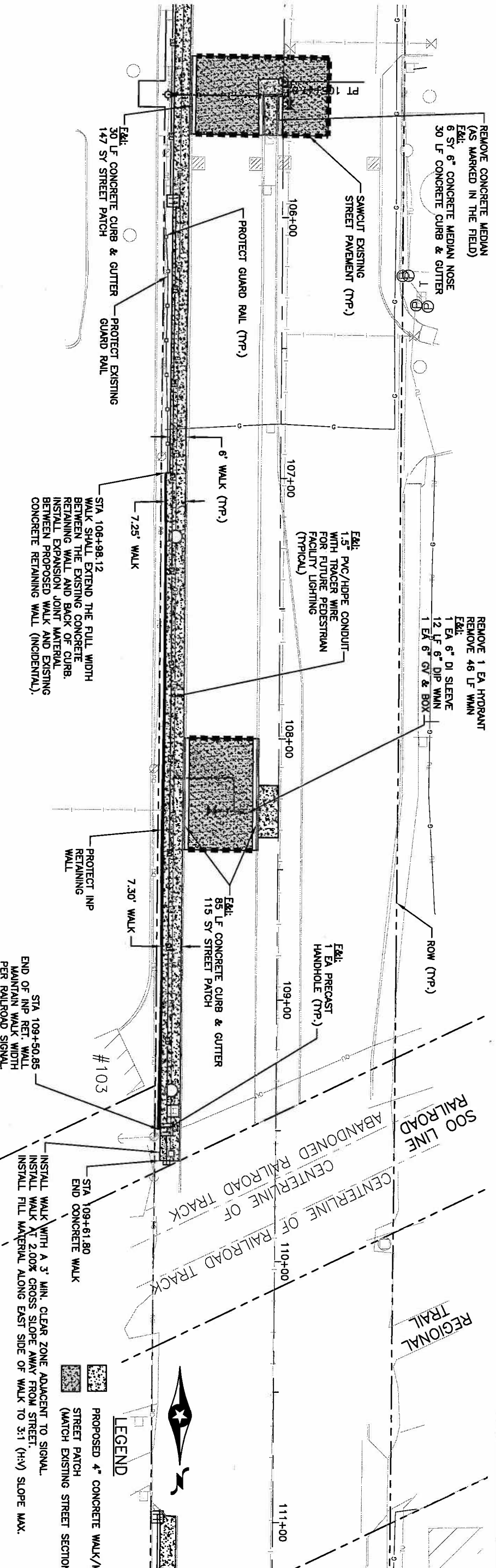
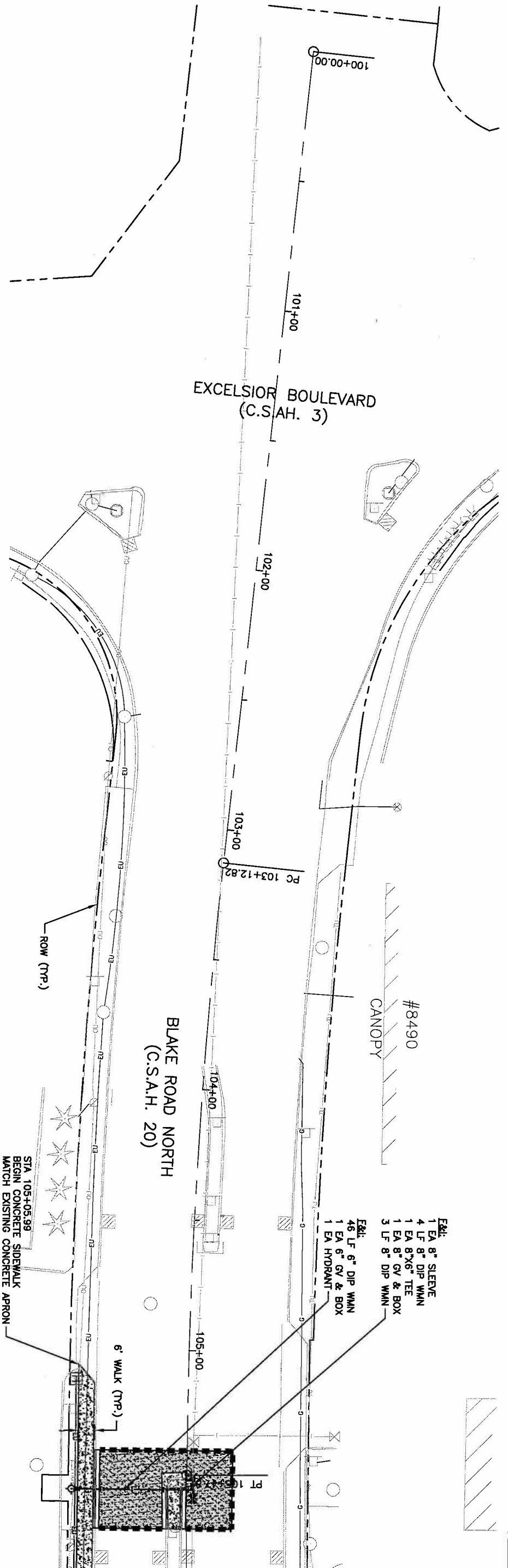

H:\WORK\116100294\PLANS\Sheet 4\_Construction Proposals 6/10/09 4:14 pm

HORIZ. SCALE 0 20 40 FEET

DESIGNED BY: M/W SER  
 CHECKED BY: M/W SER

**BOLTON & MENK, INC.**  
 Consulting Engineers & Surveyors  
 WAKARUSA, MN FAIRMOUNT, MN SLEEPY EYE, MN WILLMAR, MN  
 BURNSVILLE, MN CHASKA, MN RAMSEY, MN AMES, IA

REV.	BY	DATE

CITY OF HOPKINS  
 BLAKE ROAD SIDEWALK IMPROVEMENTS  
 100+00.00 - 110+00.00

SHEET 4 OF 9

HEREBY CERTIFY THAT THIS PLAN, SPECIFICATION, OR REPORT WAS PREPARED BY ME OR UNDER MY CLOSE PERSONAL SUPERVISION AND THAT I AM A LICENSED PROFESSIONAL ENGINEER UNDER THE LAWS OF THE STATE OF MINNESOTA.

SRARH E. RIPPE  
 Lic. No. 466336 DATE

PROPOSED 4" CONCRETE WALK/MEDIAN  
 STREET PATCH  
 (MATCH EXISTING STREET SECTION)

LEGEND

INSTALL WALK WITH A 3' MIN. CLEAR ZONE ADJACENT TO SIGNAL.  
 END OF INP RET. WALL AT 2.00% CROSS SLOPE AWAY FROM STREET.  
 INSTALL FILL MATERIAL ALONG EAST SIDE OF WALK TO 3:1 (H:V) SLOPE MAX. PER RAILROAD SIGNAL.

REMOVE CONCRETE MEDIAN (AS MARKED IN THE FIELD)  
 E&L: 6" 6" CONCRETE MEDIAN NOSE  
 30 LF CONCRETE CURB & GUTTER

REMOVE 1 EA HYDRANT  
 REMOVE 46 LF WMN  
 E&L: 1 EA 6" DI SLEEVE  
 12 LF 6" DIP WMN  
 1 EA 6" GV & BOX

REMOVE 6" 6" CONCRETE CURB & GUTTER  
 30 LF CONCRETE CURB & GUTTER

REMOVE 1 EA HYDRANT  
 REMOVE 46 LF WMN  
 E&L: 1 EA 6" DI SLEEVE  
 12 LF 6" DIP WMN  
 1 EA 6" GV & BOX

REMOVE 1 EA HYDRANT  
 REMOVE 46 LF WMN  
 E&L: 1 EA 6" DI SLEEVE  
 12 LF 6" DIP WMN  
 1 EA 6" GV & BOX

REMOVE 6" 6" CONCRETE CURB & GUTTER  
 30 LF CONCRETE CURB & GUTTER

REMOVE 1 EA HYDRANT  
 REMOVE 46 LF WMN  
 E&L: 1 EA 6" DI SLEEVE  
 12 LF 6" DIP WMN  
 1 EA 6" GV & BOX



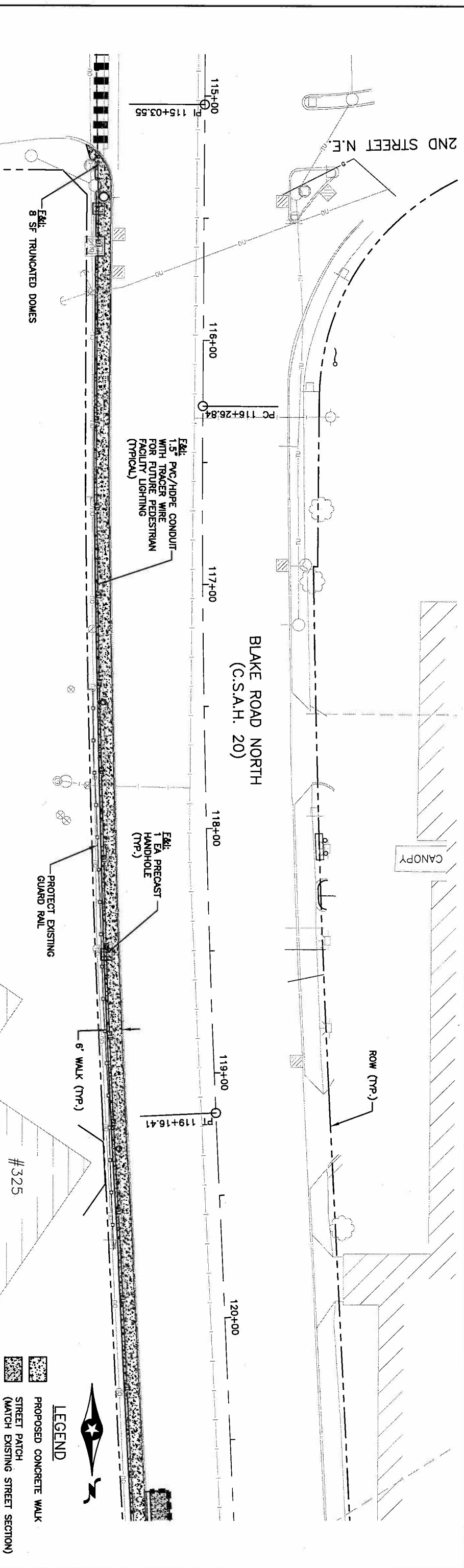
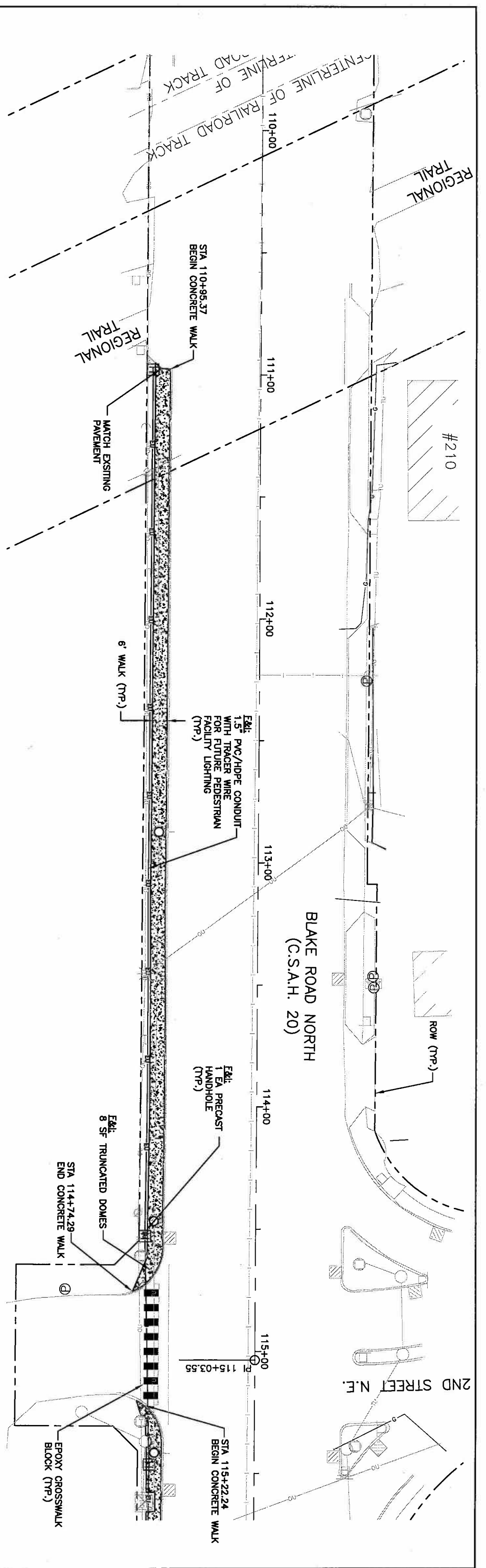

1. HEREBY CERTIFY THAT THIS PLAN, SPECIFICATION, OR REPORT WAS PREPARED BY ME OR UNDER MY DIRECT SUPERVISION AND THAT I AM A DULY LICENSED PROFESSIONAL ENGINEER UNDER THE LAWS OF THE STATE OF MINNESOTA.

SARAH E. RIPPE  
DATE: 4/6/25

DESIGNED	DRAWN	CHECKED	DATE
MJM	MJM	SR	

**BOLTON & MENK, INC.**  
Consulting Engineers & Surveyors  
WANKATO, MN FARMHOUT, MN SLEEPY EYE, MN WILLMAR, MN  
BURNSVILLE, MN CHASKA, MN RAMSEY, MN AMES, IA

REV.	BY	DATE

CITY OF HOPKINS  
BLAKE ROAD SIDEWALK IMPROVEMENTS  
CONSTRUCTION PLAN  
110+00.00 - 120+00.00

SHEET 5 OF 9

LEGEND  
 PROPOSED CONCRETE WALK  
 STREET PATCH  
 (MATCH EXISTING STREET SECTION)

HORIZ. SCALE 0 20 40 FEET  
DATE: 6/9/25 6:59 pm  
Ecolution & Work, Inc. 2025. All Rights Reserved

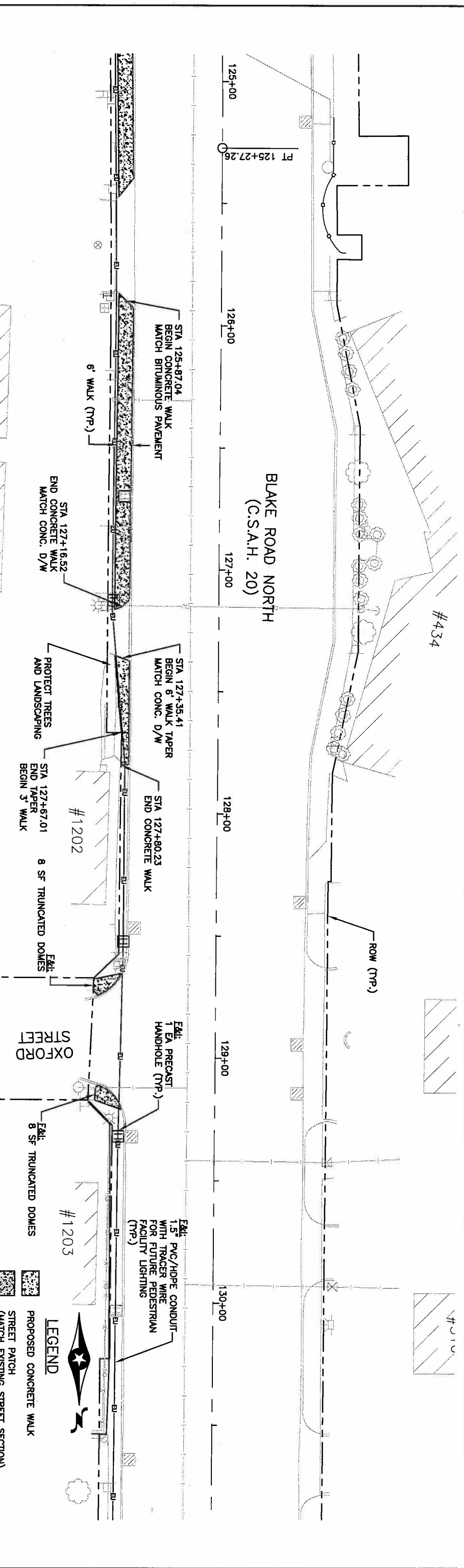
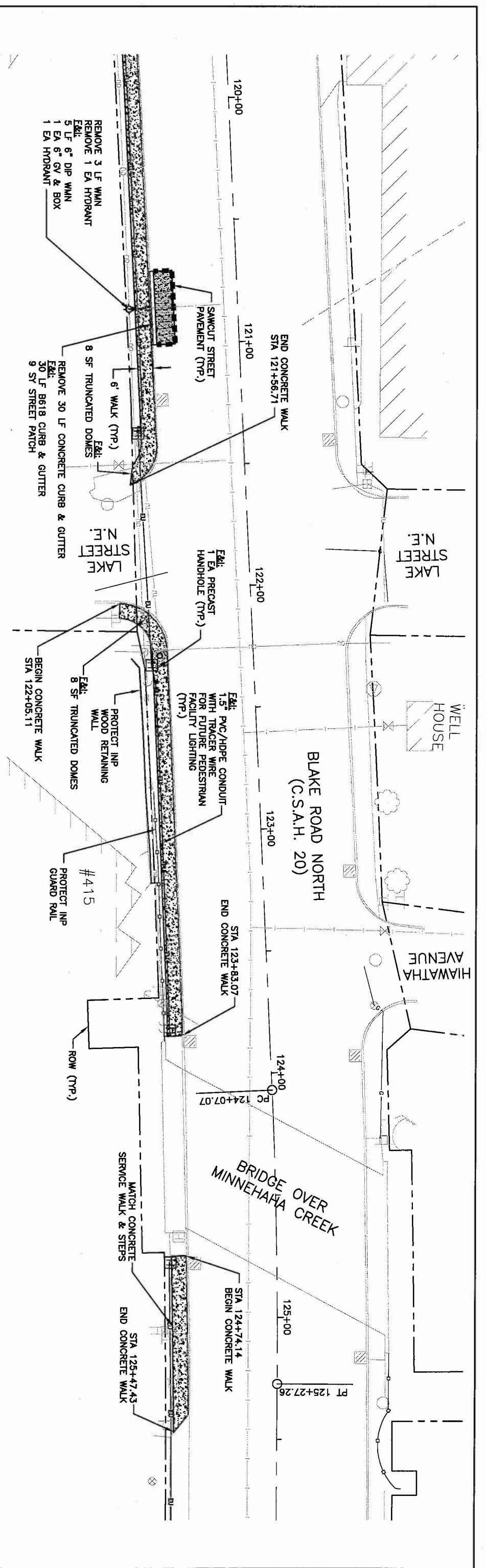

1. HEREBY CERTIFY THAT THIS PLAN, SPECIFICATION, OR REPORT WAS PREPARED BY ME OR UNDER MY DIRECT SUPERVISION AND THAT I AM A DULY LICENSED PROFESSIONAL ENGINEER UNDER THE SEAL OF THE STATE OF MINNESOTA.

SARAH E. RIPPKE  
DATE: \_\_\_\_\_

DESIGNED: M/W  
DRAWN: M/W  
CHECKED: SER

**BOLTON & MENK, INC.**  
Consulting Engineers & Surveyors  
MAKATO, MN FARMONT, MN SLEEPY EYE, MN WILLIAMS, MN  
BURNSVILLE, MN CHASKA, MN RAMSEY, MN AMES, IA

REVISIONS:

NO.	BY	DATE	DESCRIPTION

CITY OF HOPKINS  
BLAKE ROAD SIDEWALK IMPROVEMENTS  
CONSTRUCTION PLAN  
120+00.00 - 130+00.00

SHEET 6 OF 9

H:\WORK\11610294\PLANS\Sheet 6-Construction Plan.dwg 6/10/09 4:16 pm

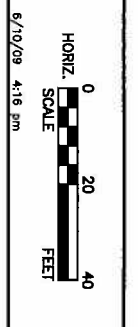

0 20 40  
FEET

DATE: \_\_\_\_\_

**BOLTON & MENK, INC.**  
Consulting Engineers & Surveyors  
MAKATO, MN FARMONT, MN SLEEPY EYE, MN WILLIAMS, MN  
BURNSVILLE, MN CHASKA, MN RAMSEY, MN AMES, IA

REVISIONS:

NO.	BY	DATE	DESCRIPTION

CITY OF HOPKINS  
BLAKE ROAD SIDEWALK IMPROVEMENTS  
CONSTRUCTION PLAN  
120+00.00 - 130+00.00

SHEET 6 OF 9



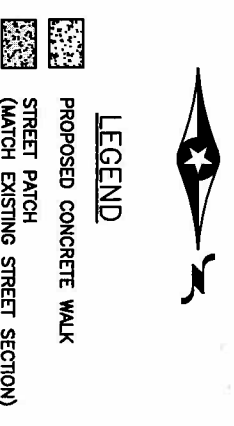
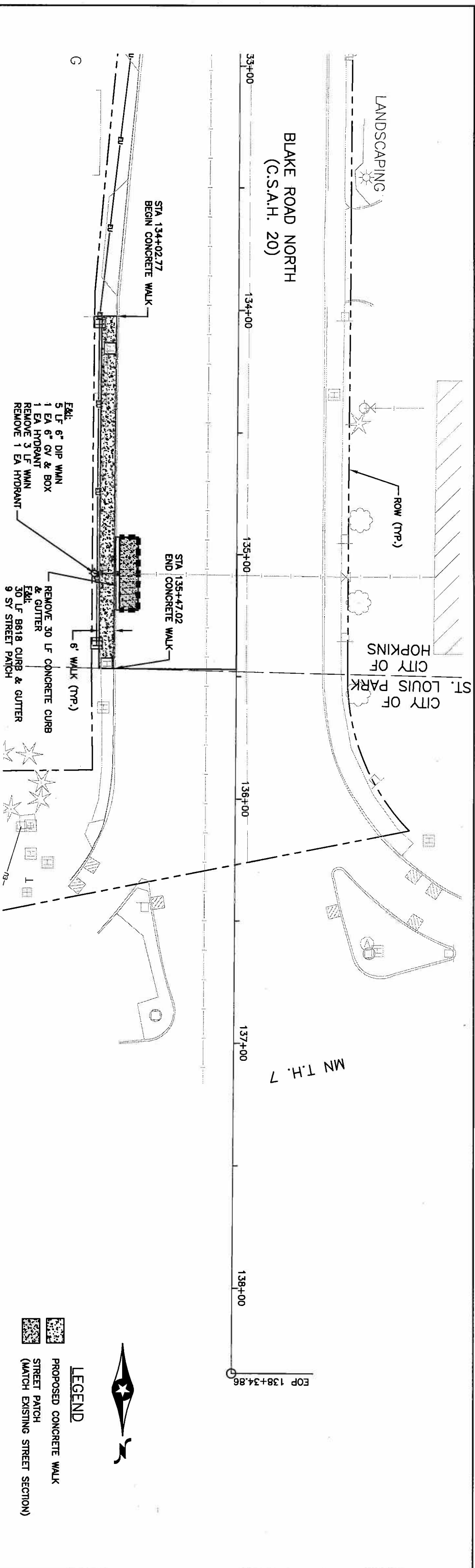
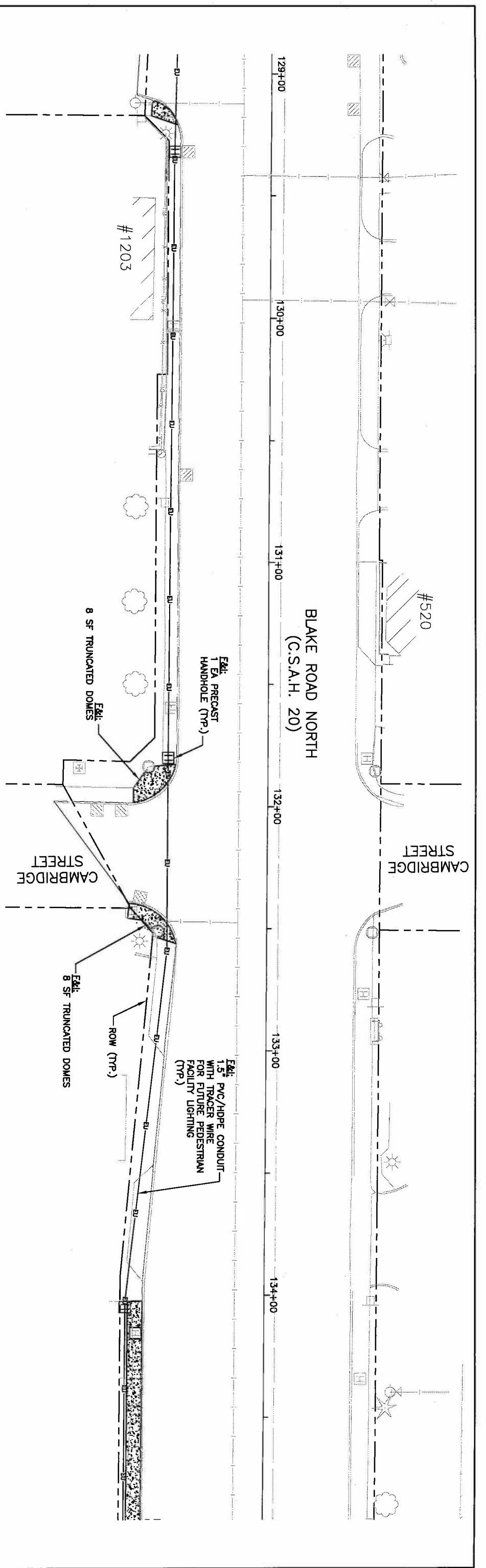

H:\WORK\116100794 PLANS\Sheet 7-Construction Permits 6/9/09 6:56 pm  
 HORIZ. SCALE 0 20 40 FEET  
 Bolton & Menk, Inc. 2009. All Rights Reserved.  
 1. HEREBY CERTIFY THAT THIS PLAN, SPECIFICATION, OR REPORT WAS PREPARED BY ME OR UNDER MY DIRECT SUPERVISION AND THAT I AM A DULY LICENSED PROFESSIONAL ENGINEER UNDER THE LAWS OF THE STATE OF MINNESOTA.  
 SARAH E. RIPPE, DATE: 6/9/09, LIC. NO. 469305  
 DESIGNED: M.J.W. DRAWN: M.J.W. CHECKED: SER.  
**BOLTON & MENK, INC.**  
 Consulting Engineers & Surveyors  
 WAKKATO, MN. PARSONT, MN. SLEEPY EYE, MN. WILLIAR, MN. BURNSVILLE, MN. CHASKA, MN. RAMSEY, MN. AMES, IA.  
 REV. BY DATE  
 CITY OF HOPKINS  
 BLAKE ROAD SIDEWALK IMPROVEMENTS  
 129+00.00 - 138+34.86  
 SHEET 7 OF 9

## EROSION CONTROL NOTES

- A. ALL CONTRACTORS AND SUBCONTRACTORS INVOLVED WITH STORM WATER POLLUTION PREVENTION SHALL BE RESPONSIBLE FOR THE STORM WATER POLLUTION PREVENTION PLAN GENERAL PERMIT (NPDES PERMIT) AND BECOME FAMILIAR WITH THEIR CONTENTS.
- B. CONTRACTOR SHALL IMPLEMENT BEST MANAGEMENT PRACTICES AS REQUIRED BY THIS SWPPP. ADDITIONAL BEST MANAGEMENT PRACTICES SHALL BE IMPLEMENTED AS DETERMINED BY THE ENGINEER AT NO ADDITIONAL COST TO OWNER THROUGHOUT ALL PHASES OF CONSTRUCTION.
- C. BEST MANAGEMENT PRACTICES (BMP'S) AND CONTROLS SHALL CONFORM TO FEDERAL, STATE AND LOCAL REGULATIONS FOR MANUAL AND AUTOMATIC APPLICABLE CONTRACTOR SHALL IMPLEMENT ADDITIONAL CONTROLS AS DIRECTED BY OWNER.
- D. ALL WASH WATER (CONCRETE TRUCKS, VEHICLE CLEANING, EQUIPMENT CLEANING, ETC.) SHALL BE DETAILED AND PROPERLY TREATED OR DISPOSED.
- E. DUST ON THE SITE SHALL BE CONTROLLED. THE USE OF MOTOR OILS AND OTHER PETROLEUM BASED OR TOXIC LIQUIDS FOR DUST SUPPRESSION OPERATIONS IS PROHIBITED.
- F. ALL EXPOSED SOIL AREAS MUST BE STABILIZED AS SOON AS POSSIBLE TO LIMIT SOIL EROSION BUT IN NO CASE LATER THAN 7 DAYS AFTER THE CONSTRUCTION ACTIVITY IN THAT PORTION OF THE SITE HAS TEMPORARILY OR PERMANENTLY CEASED.
- G. THE NORMAL WETTED PERIMETER OF ANY TEMPORARY OR PERMANENT DRAINAGE DITCH OR SWALE THAT DRAINS WATER FROM ANY PORTION OF THE CONSTRUCTION SITE, OR DIVERSITY FROM THE ROADWAY SHALL BE STABILIZED WITHIN 24 HOURS OF THE PROPERLY EDGE OR FROM THE POINT OF DISCHARGE INTO ANY SURFACE WATER. STABILIZATION OF THE LAST 200 LINEAL FEET MUST BE COMPLETED WITHIN 24 HOURS AFTER CONNECTING TO A SURFACE WATER.
- H. IF THE ACTION OF VEHICLES TRAVELING OVER THE ROCK CONSTRUCTION ENTRANCES IS SUCH THAT ROCKS ARE SPILLED OR DROPPED FROM THE VEHICLE, THESE ROCKS SHALL BE WASHED BEFORE THE VEHICLE ENTERS PUBLIC ROAD. IF WASHING IS USED, ROCKS MUST BE MADE TO INTERCEPT THE WASH WATER AND TRAP THE SEDIMENT BEFORE IT IS CARRIED OFF THE SITE.
- I. ALL MATERIALS SPILLED, DROPPED, WASHED, OR TRACKED FROM VEHICLES ONTO ROADWAYS OR INTO STORM DRAINS MUST BE REMOVED IMMEDIATELY. (INCIDENTAL)
- J. CONTRACTORS OR SUBCONTRACTORS WILL BE RESPONSIBLE FOR REMOVING SEDIMENT THAT MAY HAVE COLLECTED IN THE STORM SEWER DRAINAGE SYSTEMS IN CONJUNCTION WITH THE STABILIZATION OF THE SITE.
- K. ON-SITE & OFF-SITE SOIL, STOCKPILE AND BORROW AREAS SHALL BE PROTECTED FROM EROSION AND SEDIMENTATION THROUGH IMPLEMENTATION OF BEST MANAGEMENT PRACTICES. STOCKPILE AND BORROW AREA LOCATIONS SHALL BE NOTED ON THE SITE MAP AND PERMITTED IN ACCORDANCE WITH GENERAL PERMIT REQUIREMENTS.
- L. SLOPES SHALL BE LEFT IN A ROUGHENED CONDITION DURING THE GRADING PHASE TO REDUCE RUNOFF VELOCITIES AND EROSION.
- M. DUE TO THE GRADE CHANGES DURING THE DEVELOPMENT OF THE PROJECT, THE CONTRACTOR SHALL BE RESPONSIBLE FOR ADJUSTING THE EROSION CONTROL MEASURES (SILT FENCES, EROSION CONTROL, BLANKET, ETC.) TO PREVENT EROSION. (INCIDENTAL)
- N. ALL CONSTRUCTION SHALL BE STABILIZED AT THE END OF EACH WORKING DAY. THIS INCLUDES BACKFILLING OF TRENCHES FOR UTILTY CONSTRUCTION AND PLACEMENT OF GRAVEL OR BITUMINOUS PAVING FOR TRAIL CONSTRUCTION.
- O. THE CONTRACTOR SHALL BE RESPONSIBLE FOR MAINTAINING AN INSPECTION LOG IN ACCORDANCE WITH THE REQUIREMENTS OF THIS SWPPP.

## GENERAL PROJECT INFORMATION:

**PROJECT NARRATIVE:**  
This is project involves reconstructing the existing roadway. The project consists of grading, base, bituminous and concrete street patching, sidewalk installation and condition installation. All existing drainage patterns shall be maintained.

### RESPONSIBLE PARTIES:

Contractor and owner shall identify a person knowledgeable and experienced in the application of erosion prevention and sediment control BMP's who will oversee the implementation of the SWPPP.

<b>CITY OF HOPKINS</b>	<b>JOHN BRADFORD</b>	<b>852-548-6356</b>
Owner:	Contact Person:	Phone:
<b>BOLTON &amp; MENK, INC.</b>	<b>MIKE WALTMAN</b>	<b>612-221-6946</b>
Plan Preparer:	Contact Person:	Phone:
Contractor:	Contact Person:	Phone:
Person Responsible for Inspections:	Contact Person:	Phone:

## GENERAL PROJECT INFORMATION:

**STORM WATER MANAGEMENT:**  
Type of permanent storm water management that will be used if more than one acre of new impervious surface is created or checked below:  
 Wet sedimentation basin  
 Infiltration / Filtration  
 Regional Pond (RRR Detention Basin)  
 Alternative methods  
 Dead Storage Required: N/A  
 Dead Storage Provided: N/A  
 Elevation of Maintained Water: N/A  
 Water Quality Volume: N/A  
 Elevation of Water Quality Volume Storage: N/A  
 Surface Area of Water Quality Volume Storage: N/A  
 Allowable Discharge of Water Quality Volume: N/A  
 Designated Discharge for Water Quality Volume: N/A

**RECEIVING WATERS:**  
Surface waters which will receive storm water from the site within one (1) mile of project boundary. Include waters shown on USGS 7.5 minute quad and all waters identified in Appendix A of the permit.

Name of Water Body	Type (ditch, pond, wetland, lake, etc.)	Appendix A Special Water?
Minnesota Creek	Creek/Stream	No

There is one impervious water within one (1) mile of this project, Minnesota Creek. The water was identified as impervious due to fish bioassessments, fecal coliform, and Chloride. Discharges to waters impervious for only non-construction related parameters, such as these, do not require any additional best management practices (BMPs) or plan review for compliance with the NPDES/SDS construction permit.

## CONSTRUCTION ACTIVITY NOTES:

### EROSION PREVENTION:

Construction of silt fence and all other erosion control measures shall be complete before other construction activity occurs.  
Use phased construction wherever practical and establish turf as soon as possible to minimize sediment transport.

All exposed soil areas must be stabilized as soon as possible to limit soil erosion but in no case later than seven (7) days after the construction activity in that portion of the site has temporarily or permanently ceased.

All exposed soils shall be sodded at the earliest possible time to prevent/reduce erosion.

Energy dissipation or other outlet treatment must be installed within 24 hours of connection to surface water.

Additional erosion prevention measures may be found in the permit and MPCA's Best Management Practices.

### SEDIMENT CONTROL PRACTICES:

Construction of silt fence and all other erosion control measures shall be complete prior to land disturbing activities occur.

Inlet erosion protection shall be installed and maintained until turf or pavement has been established.

The contractor shall be responsible to control erosion from leaving the construction zone. All eroded material that leaves the construction zone shall be collected by the contractor and returned to the site at the contractor's expense.

All streets must be swept when any tracking occurs.

## CONSTRUCTION ACTIVITY NOTES:

### DEWATERING AND BASIN DRAINING:

Dewater sediment-laden water to sedimentation basins if possible, or use other BMP's to prevent erosion when discharging to surface waters. Use appropriate energy dissipation measures on all discharges.

Dewatering practices cannot cause nuisance conditions, erosion or in receiving channels or inundation of wetlands resulting in adverse impacts.

### POLLUTION PREVENTION:

All solid waste collected from the construction site must be disposed in accordance with all applicable regulations.

All hazardous materials (oil, gasoline, fuel, paint, etc.) must be properly stored to prevent spills, leaks or other discharges. Storage and disposal of hazardous waste must be in compliance with all applicable regulations.

External washing areas must be limited to a defined area of the site. All runoff containing any hazardous material must be properly collected and disposed of. Defined area must be contained with heavy- or super-duty silt fence. NO ENGINE DERRISING IS ALLOWED ON SITE.

Equipment maintenance areas must be limited to a defined area of the site. All runoff containing any hazardous material must be properly collected and disposed.

The contractor is responsible for monitoring air pollution and ensuring it does not exceed levels set by local, state, or federal regulations. This includes dust created by work being performed on the site. Air pollution and dust control correction is considered incidental to the limit bid prices for which work is being performed. Additional dust control measures may be required by the Engineer.

### INSPECTION AND MAINTENANCE:

The Contractor must routinely inspect the construction site once every seven (7) days during active construction and within 24 hours of a rainfall event greater than 0.5 inches in a 24 hrs.

All inspections performed during construction must be recorded and records retained with the SWPPP in accordance with the Stormwater Permit.

Silt fence, bioerode and inlet protection devices must be maintained when accumulated sediment reaches ½ of device height.

Temporary sediment basins to be cleaned within 72 hours of the filling of ½ of the original storage volume.

Off site vehicle tracking to be removed within 24 hours of occurrence.

All non-functional BMPs must be repaired, replaced, or supplemented with functional BMPs within 24 hours of discovery, or as soon as field conditions allow access.

### FINAL STABILIZATION:

The Contractor must ensure final stabilization of the site.

All temporary erosion control measures and BMP's must be removed as part of the final site stabilization.

The storm water permit further defines final stabilization and its requirements.

### IMPLEMENTATION SCHEDULE & PHASING:

- 1) Install silt fence and inlet protection to catch basins as necessary.
- 2) Clear, grub, demolition, rough grade site and remove existing bituminous.
- 3) Complete utility construction and roadway construction.
- 4) Maintain inlet protection devices.
- 5) Stabilize site as indicated on the plans.
- 6) Ensure final stabilization measures complete.
- 7) Notify the Owner of final stabilization, when complete.

### RECORD RETENTION:

The SWPPP all changes to it, and inspections and maintenance records must be kept at the site during construction.

The Contractor must retain the following for 3 years after closeout of the project:

- 1) SWPPP.
- 2) Any other permits required for the project.
- 3) Inspection and maintenance logs.
- 4) All permanent operation and maintenance agreements for surface water facilities.
- 5) All design calculations for temporary and permanent storm water management.

### TRAINING:

The Contractor must comply with the training requirements of the contract.

I HEREBY CERTIFY THAT THIS PLAN, SPECIFICATION, OR REPORT WAS PREPARED BY ME OR UNDER MY DIRECT SUPERVISION AND THAT I AM A DULY LICENSED PROFESSIONAL ENGINEER UNDER THE LAWS OF THE STATE OF MINNESOTA.  
 SARAH E. RIPPE  
 Lic. No. 458335 DATE \_\_\_\_\_

DESIGNED  
 M.A.W.  
 DRAWN  
 M.A.W.  
 CHECKED  
 S.E.R.

**BOLTON & MENK, INC.**  
 Consulting Engineers & Surveyors  
 WAKATO, MN FAIRBANK, MN SLEEPY EYE, MN WILLMAR, MN  
 BURNSVILLE, MN CHASKA, MN RAMSEY, MN AMES, IA

REV.	BY	DATE	CITY OF HOPKINS BLAKE ROAD SIDEWALK IMPROVEMENTS
			STORMWATER POLLUTION PREVENTION PLAN

100+00.00 - 138+34.86



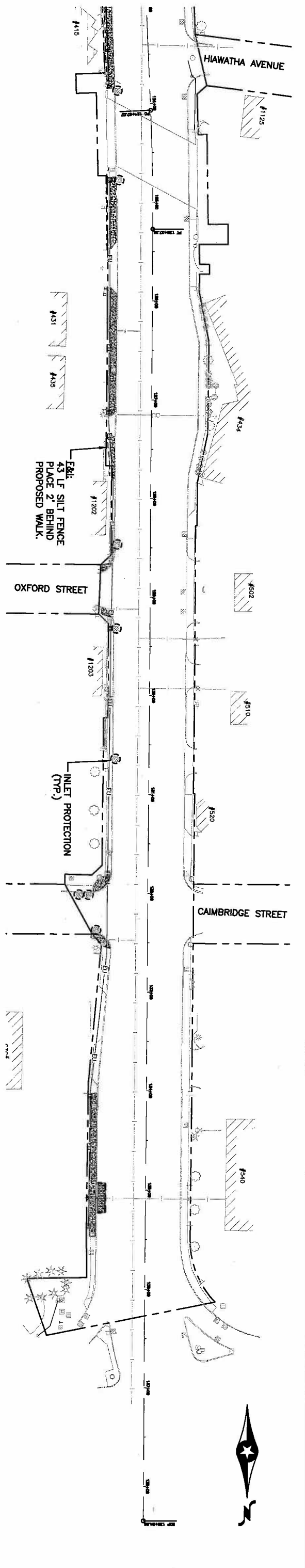
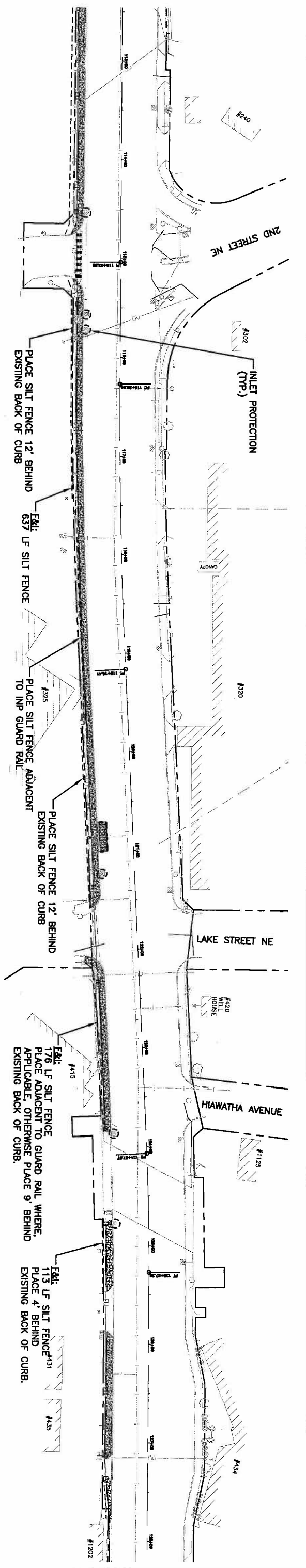
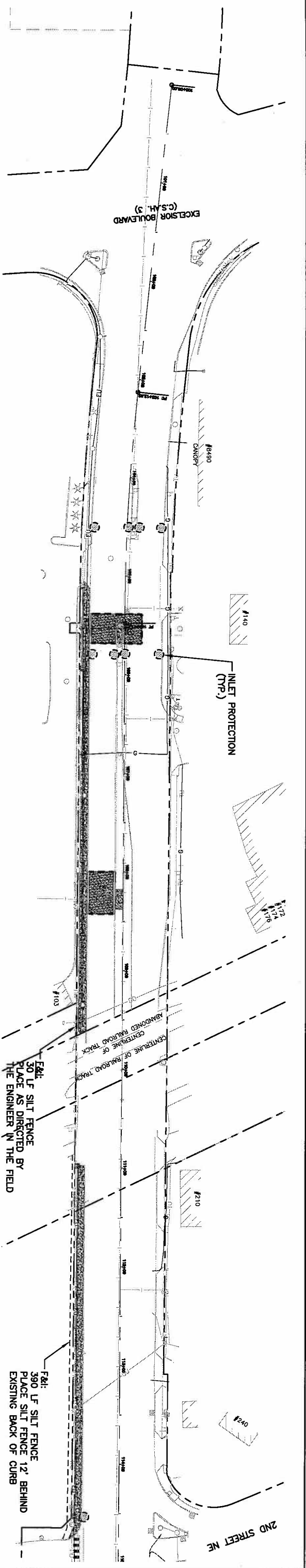

H:\WORK\116100794\PLANS\Sheet 9 SWPPP.dwg 6/8/09 11:51 am  
 HORIZ. SCALE 1" = 50' FEET  
 I HEREBY CERTIFY THAT THIS PLAN, SPECIFICATION, OR REPORT WAS PREPARED BY ME OR UNDER MY DIRECT SUPERVISION AND THAT I AM A FULLY LICENSED PROFESSIONAL ENGINEER UNDER THE LAWS OF THE STATE OF MINNESOTA.  
 SARAH E. RIPPKE  
 LIC. NO. 486335 DATE \_\_\_\_\_  
 DESIGNED: M.J.W. DRAWN: M.J.W. CHECKED: SER.  
**BOLTON & MENK, INC.**  
 Consulting Engineers & Surveyors  
 WANKATO, MN FARIBOULT, MN SLEEPY EYE, MN WILLMAR, MN  
 BURNSVILLE, MN CHASKA, MN ROSEBURY, MN AMES, IA  
 CITY OF HOPKINS  
 BLAKE ROAD SIDEWALK IMPROVEMENTS  
 STORMWATER POLLUTION PREVENTION PLAN  
 100+00.00 - 138+34.86  
 SHEET 9 OF 9