

	SCHOOL	ZONE	FLASHER
1)	SCHOOL	ZONE	FLASHER
2)	PEP X		
3)	PEP X		
4)	SCHOOL	ZONE	FLASHER
5)	FLASHING	STOD	
6)	FLASHING	STOD	
7)	PEP X		
8)	PEP X		
9)	PEP X		
10)	PEP X		
11)	FLASHING	STOD	
12)	FLASHING	STOD	
13)	PEP X		
14)	PEP X		
15)	SCHOOL	ZONE	SPEED
16)	SCHOOL	ZONE	SPEED
17)	SCHOOL	ZONE	SPEED
18)	SCHOOL	ZONE	SPEED
19)	PEP X		
20)	PEP X		
21)	PEP X		
22)	PEP X		
23)	SCHOOL	ZONE	FLASHER
24)	SCHOOL	ZONE	FLASHER

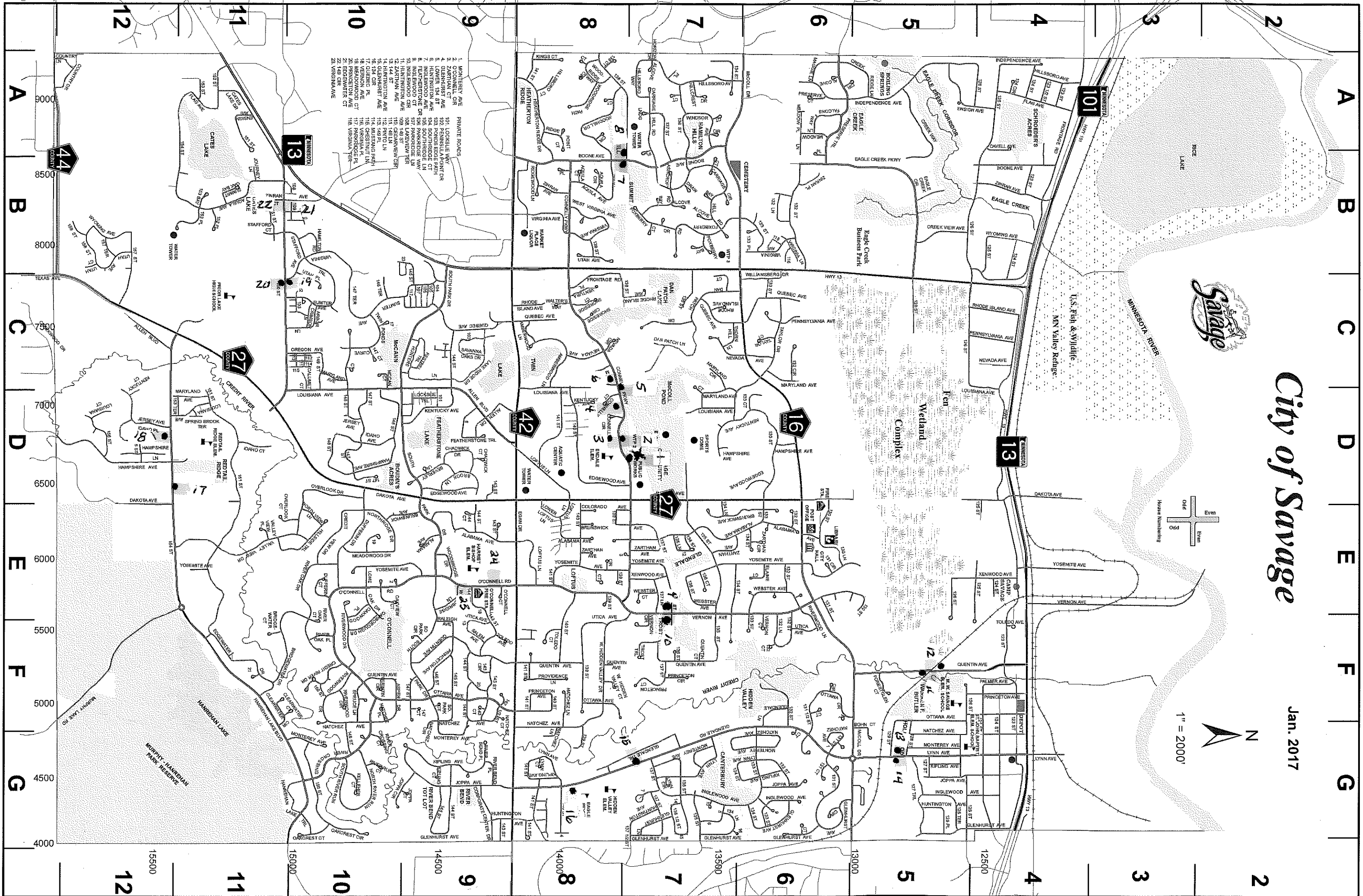

City of Savage

Jan. 2017

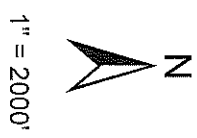
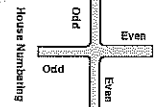

City of Savage
GIS Map Production

This drawing is not a legally recorded plat or an accurate survey. It is intended to be only an approximate representation of information from various governmental offices and other sources. It should not be used for a purpose that requires exact measurements or boundaries. The City of Savage is not responsible for any inaccuracies contained in this drawing. The City of Savage provides no warranty, express or implied, about the correctness of the information.